

RH-Series Retro-fit High-2-Low™ Lighting System

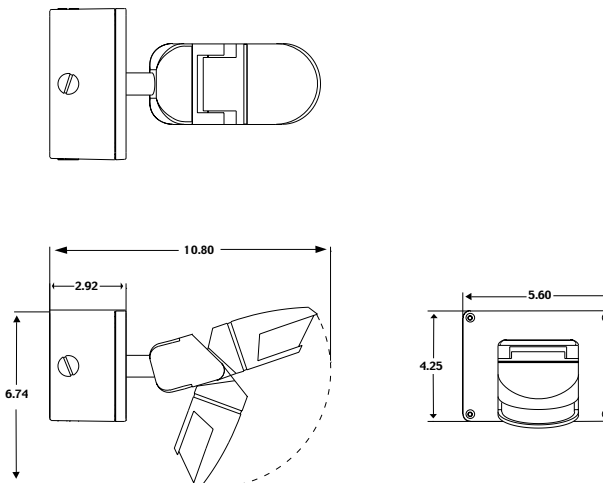

RHL, RHM and RHS Series



RH Sensor

The long distance sensor will detect movement up to 50ft. from the fixture, mounted at maximum 20ft. above ground level. 180° (A) and 270° (B) are available depending on application. Ideal for car dealerships, parking areas and general outdoor service areas. A minimum 40% savings in energy can be reached.

RHL-Series/Stand Alone

Outdoor weatherproof module with sensor for fixture mounting. RHL High-Low™ retrofit can be mounted directly to any outdoor HID fixture from 175W though 1000W provided 120V or 277V tap is available on the existing ballast. This is the standard factory installed "H" option for the 16" & 23" floods and the WSL wall pack with 270° sensor.

RHM-Series/Master

A master switching module with sensor can be used for one fixture and multiple slave units (RHS) to operate a maximum of 25 fixtures from a single sensor. Consult factory on "H" - Master option for 16" & 23" floods and WSL wall pack. Low voltage wiring is required between units.

RHC-Series/Control Sensor Only

This remote sensor is used when the unit is mounted separately from the fixture it is switching. It is used in conjunction with the slave units (RHS) which are mounted to the fixture. Used when fixtures are mounted above the 20' limit of the sensor.



**RHL and RHM Series
Mounted to Fixture**

LISTED FOR WET LOCATIONS
CONSULT FACTORY FOR CUL AVAILABILITY

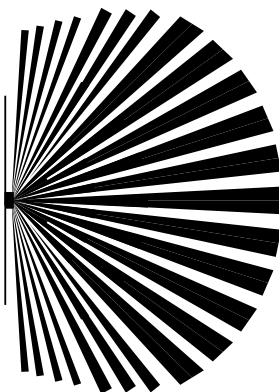

(A) 180° Coverage

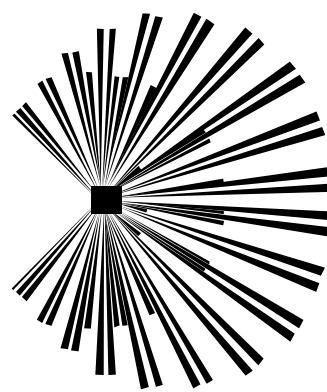

(B) 270° Coverage

RH Series Order Information

Catalog Number

	Stand Alone	Master	Slave
175W MH	RHL0417-(a)(b)(c)	RHM0417-(a)(b)(c)	RHS0417-(a)(b)(c)
250W MH	RHL0425-(a)(b)(c)	RHM0425-(a)(b)(c)	RHS0425-(a)(b)(c)
LESS 250W MH/PS	RHL0825-(a)(b)(c)	RHM0825-(a)(b)(c)	RHS0825-(a)(b)(c)
LESS 320W MH/PS	RHL0832-(a)(b)(c)	RHM0832-(a)(b)(c)	RHS0832-(a)(b)(c)
LESS 350W MH/PS	RHL0835-(a)(b)(c)	RHM0835-(a)(b)(c)	RHS0835-(a)(b)(c)
400W MH	RHL0440-(a)(b)(c)	RHM0440-(a)(b)(c)	RHS0440-(a)(b)(c)
LESS 400W MH/PS	RHL0840-(a)(b)(c)	RHM0840-(a)(b)(c)	RHS0840-(a)(b)(c)
LESS 450W MH/PS	RHL0845-(a)(b)(c)	RHM0845-(a)(b)(c)	RHS0845-(a)(b)(c)
1000W MH	RHL0499-(a)(b)(c)	RHM0499-(a)(b)(c)	RHS0999-(a)(b)(c)
250W HPS	RHL0525-(a)(b)(c)	RHM0525-(a)(b)(c)	RHS0525-(a)(b)(c)
400W HPS	RHL0540-(a)(b)(c)	RHM0540-(a)(b)(c)	RHS0540-(a)(b)(c)
1000W HPS	RHL0599-(a)(b)(c)	RHM0599-(a)(b)(c)	RHS0599-(a)(b)(c)

Control Sensor Only RHC0000-(a)(b)

(a) **Sensor Voltage** Suffix Key: Indicate sensor voltage in space (a)

Description	No Sensor	120 Volt	277 Volt
	0	1	2

(b) **Sensor Coverage** Suffix Key: Indicate sensor voltage in space (b)

Description	No Sensor	180° Sensor	270° Sensor
	0	A	B

(c) **Capacitor Values** Suffix Key: Indicate sensor voltage in space (c)

Description	10uF	15uF	24uF	35uF	48uF	55uF
	10	15	24	35	48	55

* RH-Series Retro-fit High-2-Low™ units to be used with CWA type ballasts only.

RH-Series Retro-fit High-2-Low™ Lighting System



RHS Series



RHS Series Mounted to Fixture



LISTED FOR WET LOCATIONS
CONSULT FACTORY FOR CUL AVAILABILITY

RHS-Series SLAVE

The Slave Unit is used in conjunction with either the RHC (control sensor only) where remote mounting of the sensor is required, or with the RHM (master switching module) where multiple fixtures are switched with the master sensor. A maximum of 25 slaves (RHS) can be connected to a single control or master sensor. Consult factory on "H"- Master option for 16" & 23" floods and WSL wall pack. Low voltage wiring is required between units.

